

### Construction sites

Continuously switching off the mains power supply that is connected to emergency light fittings during the construction phase of an installation will cause these fittings to discharge and charge their batteries many times over a short period; this can shorten life of the battery. ABB does not recommend such practices and

may not honour the warranty on batteries when they are subjected to such harsh operating conditions. Emergency light fittings are designed to be discharge tested once every 6 months as per AS/NZS 2293.2, subjecting the product to repeated discharge or charge cycles is regarded as an abuse of the fittings.

### Troubleshooting guide

If you have installed and connected the fitting as per the instructions listed earlier and it does not function correctly, use the following table as a guide to fixing the problem. Look up the type of fault in the left column and check the possible causes from the right column.

If the fitting still does not work after checking these possible causes, contact ABB customer service in Australia on 1800 60 20 20.

No.	Fitting type	Fault	Possible causes
1	Standard Nexus LX Nexus RF	LEDs do not light up when connected to mains	AC supply not connected or turned off; <b>or</b> Switch active turned off; <b>or</b> LEDs damaged
2	Nexus LX	Indicator LED is flashing green but AC lamp does not come on when connected to mains	Switch active turned off; <b>or</b> Lamp damaged; <b>or</b> Missing loop from unswitched to switched active
3	Nexus LX	Indicator LED is flashing green but lamp does not come on when test switch is pressed	Switch active turned off; <b>or</b> LEDs damaged; <b>or</b> Battery pack not connected or faulty; <b>or</b> Test switch damaged
4	Nexus LX	Indicator LED does not light up red after the commissioning	Battery pack not connected; <b>or</b> LED wire not properly inserted into the terminal
5	Standard Nexus LX Nexus RF	LEDs are lit momentarily when test switch is pressed or when mains fail	Battery not fully charged (allow up to 24 hours); <b>or</b> Battery pack damaged
6	Nexus LX	Indicator LED is constant green	Fitting self checks fail - return to manufacturer
7	Nexus LX Nexus RF	Fitting LED is not flashing yellow/orange under wink node command	Fitting is not receiving communication signal Check data cable wiring path and cable or RF connections Refer to Nexus user and technical guide

### ABB Australia Pty Limited

For enquiries  
ABB contact centre: 1800 60 20 20  
E-mail: AU-ABB-Stanilite@abb.com

## INSTALLATION MANUAL

### Stanilite®

### Platinum batten LED

AC, standard, Nexus® LX, Nexus RF



This document covers	What's inside the box
Safety warning	Batten LED
Installation instructions	Installation kit
Removal instructions	Installation manual
Testing precautions	Warranty information
Troubleshooting guide	

### Thank you for choosing ABB product

Please read this document thoroughly before commencing installation and retain for future reference. Contact ABB customer service in Australia on 1800 60 20 20 if you need any assistance. The installation instructions were correct at the time of print. To reflect changes in technology and Australian standards; ABB reserves the right to amend the instructions without notice. Updated document can be found on the Stanilite website.

### Safety warning

In Australia and New Zealand, only licensed electricians are permitted by law to work with 240 volt electrical installations. Do not attempt to install or connect this product unless you are a licensed electrician. Turn off and isolate the electrical supply before connecting this fitting to the building wires. Do not touch the terminals of the terminal block when the light fitting is energised. The only user-serviceable part is the battery pack. LED light source is not user-serviceable. Do not attempt to service other parts of the fitting as this will void the warranty. As the installer, it is your responsibility to ensure compliance with all relevant building and safety codes, (ie: AS/NZS 3000, AS/NZS 2293). Refer to the applicable standards for data and mains cabling installation procedures and requirements.

### Important to note:

- For electronic control fitting such as this fitting (when supplied) do not megger between A and N.
- The product must be maintained and operated in accordance with the manufacturer's instructions, failure to do so may damage the product. It is recommended that this important note be communicated to the site owner or manager and or contractor of the installation at the time of site commissioning.
- This product is designed for indoor use only.

### Nexus LX (data cable system)

The Nexus range of emergency light fittings are designed to be connected together into a special communication network over a level 4 (or higher) high speed, single twisted pair data cable. The Nexus user and technical guide describes all you need to know to successfully install a Nexus project. Ask for it from your supervisor, from your employer or from your nearest ABB product supplier. The network cabling of the building must be installed as per the procedure detailed in the Nexus user and technical guide. No mains or mains carrying cables are to be connected to the data terminals or cables.

### Nexus RF (wireless system)

The Nexus RF range of light fittings are designed to communicate via a proprietary RF network, however the electrical installation of the fittings is identical to that of a standard non-monitored fitting.

## Installation instructions

1. Disconnect the mains power to the circuit before commencing installation.

**Note: The circuit supplying mains power to the fitting must not be energised until installation of the fitting is completed.**

- The batten can be either ceiling or wall mounted or suspended. Suspension wires **not** supplied.
- Slide end caps away from the fitting and remove the lamp and diffuser assembly. Place batten against the wall or ceiling; mark and drill position of the mounting screw holes.

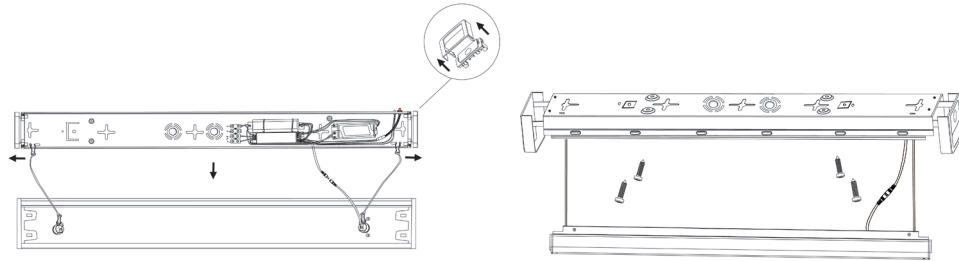

- Secure the batten to the ceiling or wall using appropriate fixings depending on the type of building construction material used. The supplied 4 pieces of wall plugs and screws can be used if appropriate, depending on the building construction material.
- Route the mains cable through the cable entry at rear and connect to the terminal block as shown below:

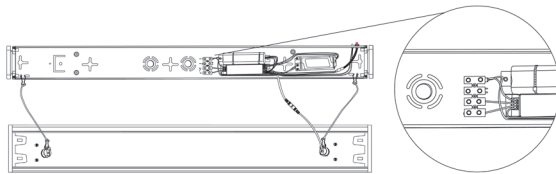

6. Be careful with multi-strand conductors that all the strands are twisted together before insertion into the terminal. Any stray strands that inadvertently encounters their neighbouring terminal will cause undesirable results when the fitting is powered.

Wire/fitting type	AC
Switched active	Wire to SA terminal
Neutral	Wire to terminal N
Earth	Wire to terminal E or

Wire/fitting type	Non-maintained	Maintained - no SA	Maintained - with SA
Switched active	Don't wire SA terminal	Loop the SA and A terminals	Wire to SA terminal
Unswitched active	Wire to terminal A	Wire to terminal A	Wire to terminal A
Neutral	Wire to terminal N	Wire to terminal N	Wire to terminal N
Earth	Wire to terminal E or	Wire to terminal E or	Wire to terminal E or

**Note: Switched active (SA) and unswitched active (A) supply must be on the same phase.**

- Verify that the battery is connected to the inverter or power pack. For Nexus LX or Nexus RF fitting; refer to the data connections section.
- Clip the diffuser and end caps back onto the fitting.

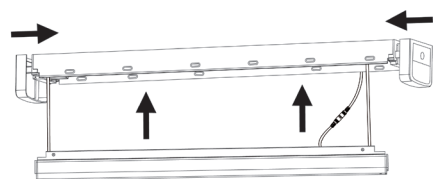

- Energise the fitting and allow a few minutes to give the battery a small charge then press the test button to ensure that the fitting is functional in emergency mode. Check LEDs operation and indicator LED per following tables. Refer to the troubleshooting guide if abnormal operation or indication is encountered.

Fitting type	Indicator LED state - on initial powering - no fitting faults
Non-monitored	Solid green
Nexus LX	Flashing green
Nexus RF	Green flash with 2 red blinks, green flash with 3 red blinks

## Data connections - Nexus LX and Nexus RF product range

### Nexus LX fitting

- Connect the data cable to the Nexus LX module via the green connector supplied as showing.
- When correctly installed no fitting should have more than 2 data cables connected to it.
- If you have more than 2 data cables at any 1 fitting, the installation is incorrect.
- If this fitting is at the end of a data cable run, a terminator needs to be wired parallel across the 2 data lines.
- If there is an in and out data cable, then the shields should be wound together, folded back and taped up.
- Consult the Nexus user and technical guide for further detail, including product commissioning.

### Nexus RF fitting

- Collect the MAC address, by removing the peel off sticker section and locating it on your floor plan or spreadsheet.
- Consult the Nexus user and technical guide for further detail, including product commissioning.

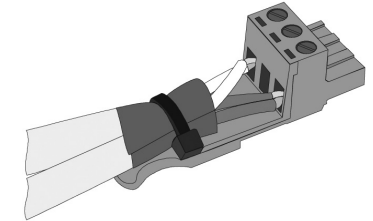

**Important: 24 hours is required to allow the fitting battery to reach full capacity, ie: prior to a discharge test. As the installer, it is your responsibility to conduct the initial discharge testing of the installed fitting. Refer to AS/NZS 2293.**

## Removal instructions

- Before removing the installed fitting, de-energise and lock off the supply circuit.
- Note: There may be 2 actives present, ensure all power is isolated before proceeding.**
- Slide end caps away from the fitting and remove the lamp and diffuser assembly from the base.
- Disconnect the battery and then remove the mains cabling from the terminal block.
- For Nexus LX; unplug the data cable connection.
- When the fitting is reconnected to the supply, it will need time to recharge its battery for 24 hours before it will be capable of a full length discharge again.

## Testing precautions

Once the fitting is permanently connected to the mains supply, a commissioning discharge test as required in AS/NZS 2293.2 must be carried out. You will need to allow 24 hours for the battery to fully charge prior to conducting this test, presently (at the time of writing), the standard requires that fittings operate in emergency mode for a period not less than 2 hours for their commissioning test and for not less than 90 minutes thereafter (it is required that 6 monthly discharge tests be carried out). You will need to keep the records for the commissioning test and enter them into the building emergency services logbook or via other recording methods as allowed by AS/NZS 2293.2.